

# GLASS WORKS

## Ground floor



### Key

- |                 |            |            |            |
|-----------------|------------|------------|------------|
| Lift / elevator | Flat No.1  | Flat No.32 | Flat No.35 |
| Kitchen         | Flat No.2  | Flat No.33 |            |
| Lounge          | Flat No.31 | Flat No.34 |            |

# GLASS WORKS

## First floor

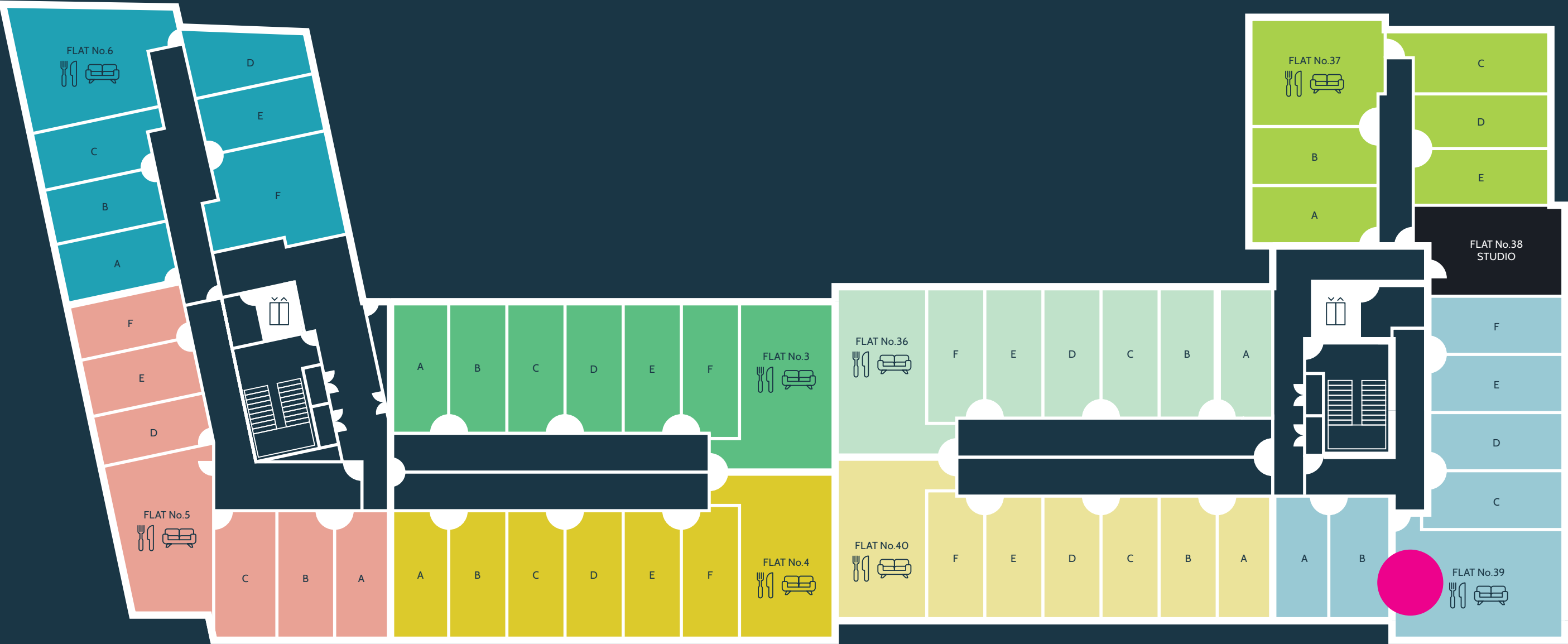

### Key

- |                 |           |            |            |
|-----------------|-----------|------------|------------|
| Lift / elevator | Flat No.3 | Flat No.6  | Flat No.38 |
| Kitchen         | Flat No.4 | Flat No.36 | Flat No.39 |
| Lounge          | Flat No.5 | Flat No.37 | Flat No.40 |

# GLASS WORKS

## Second floor

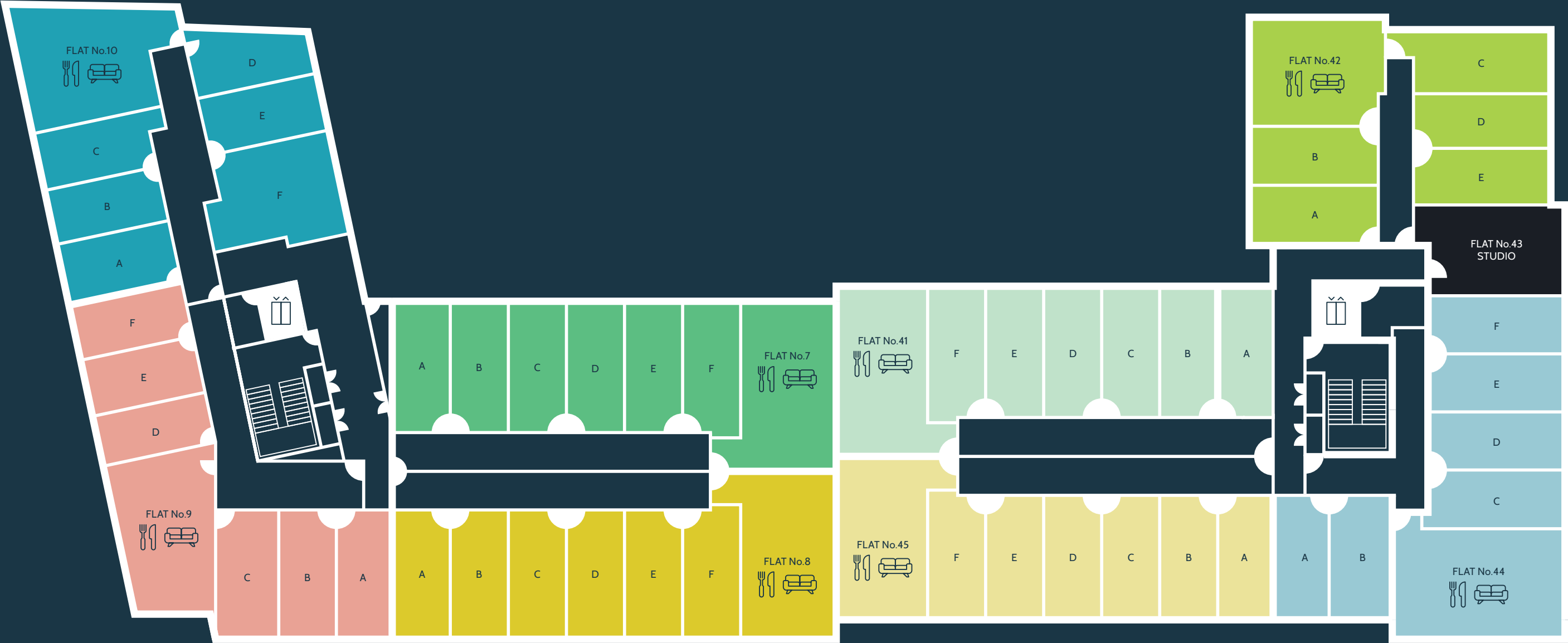

Key

Lift / elevator

Kitchen

Lounge

Flat No.7

Flat No.8

Flat No.9

Flat No.10

Flat No.41

Flat No.42

Flat No.43

Flat No.44

Flat No.45

# GLASS WORKS

## Third floor

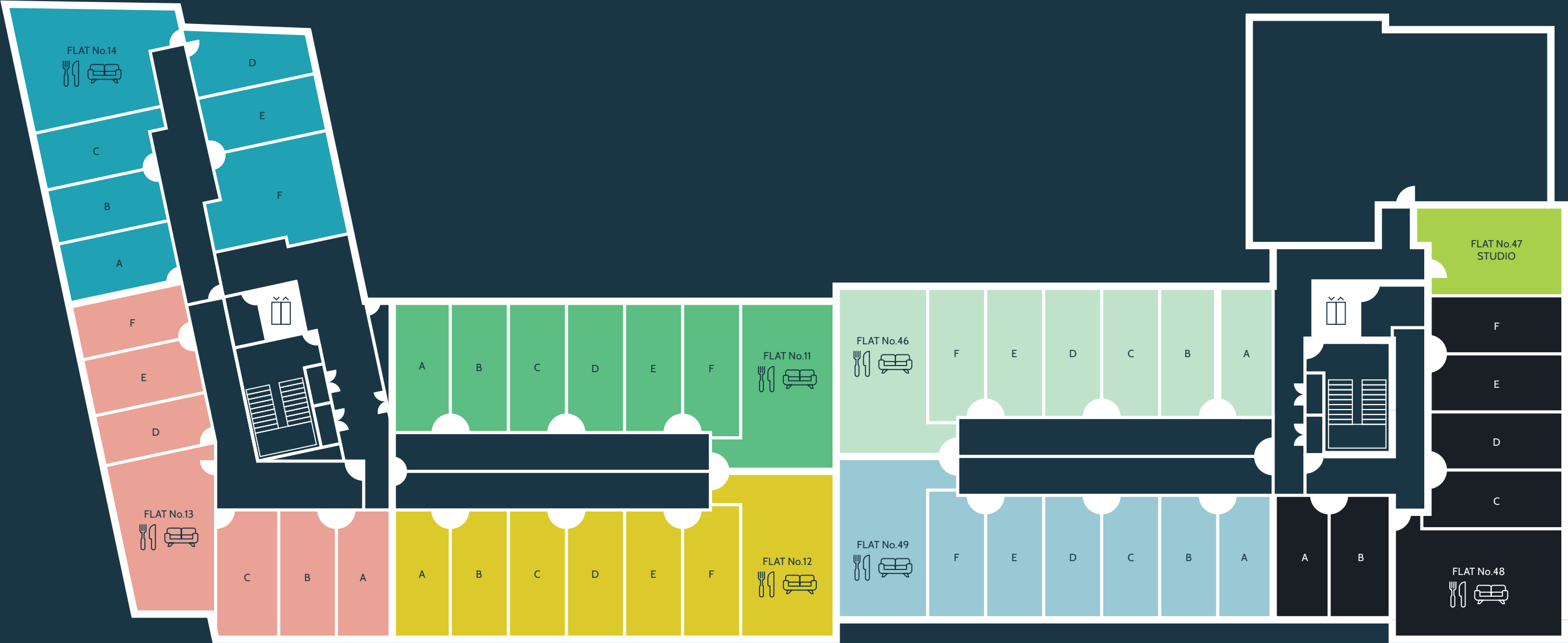

### Key

- |                 |             |             |             |
|-----------------|-------------|-------------|-------------|
| Lift / elevator | Flat No. 11 | Flat No. 14 | Flat No. 48 |
| Kitchen         | Flat No. 12 | Flat No. 46 | Flat No. 49 |
| Lounge          | Flat No. 13 | Flat No. 47 |             |

# GLASS WORKS

## Fourth floor

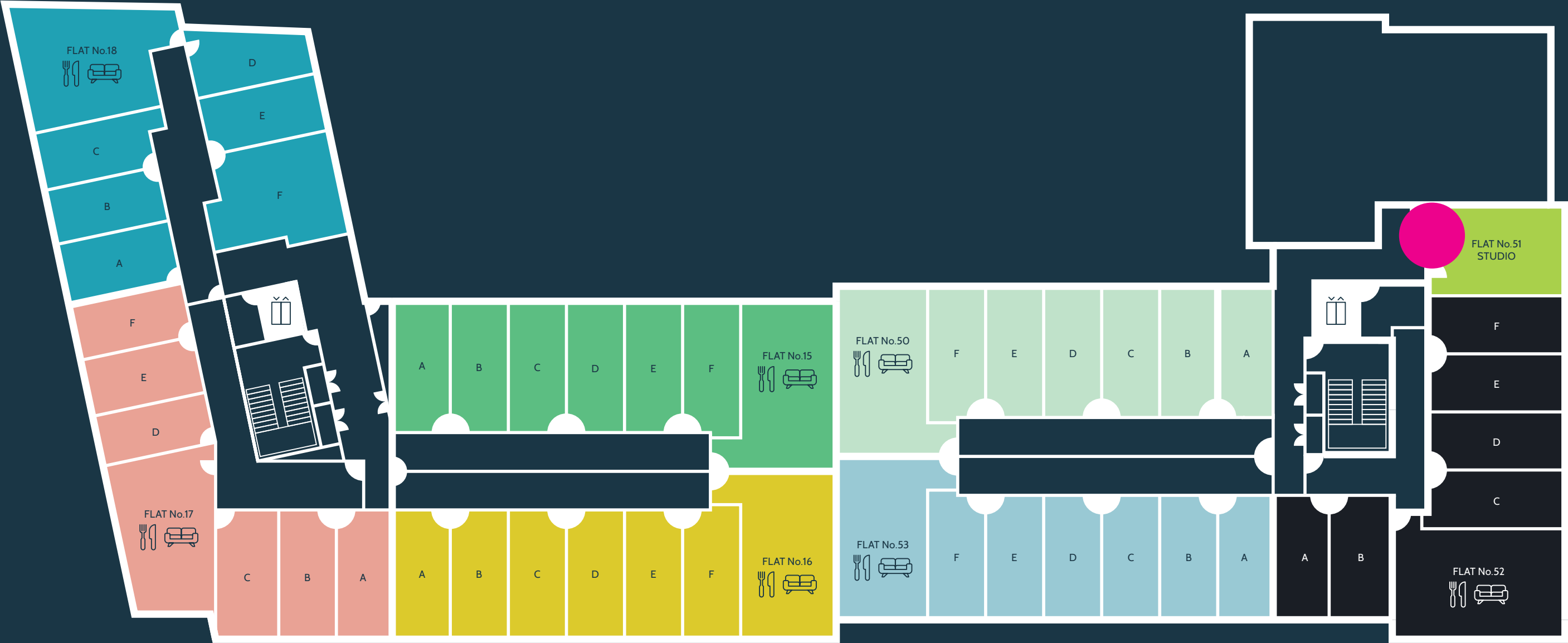

### Key

- |                 |            |            |            |
|-----------------|------------|------------|------------|
| Lift / elevator | Flat No.15 | Flat No.18 | Flat No.52 |
| Kitchen         | Flat No.16 | Flat No.50 | Flat No.53 |
| Lounge          | Flat No.17 | Flat No.51 |            |

# GLASS WORKS

## Fifth floor

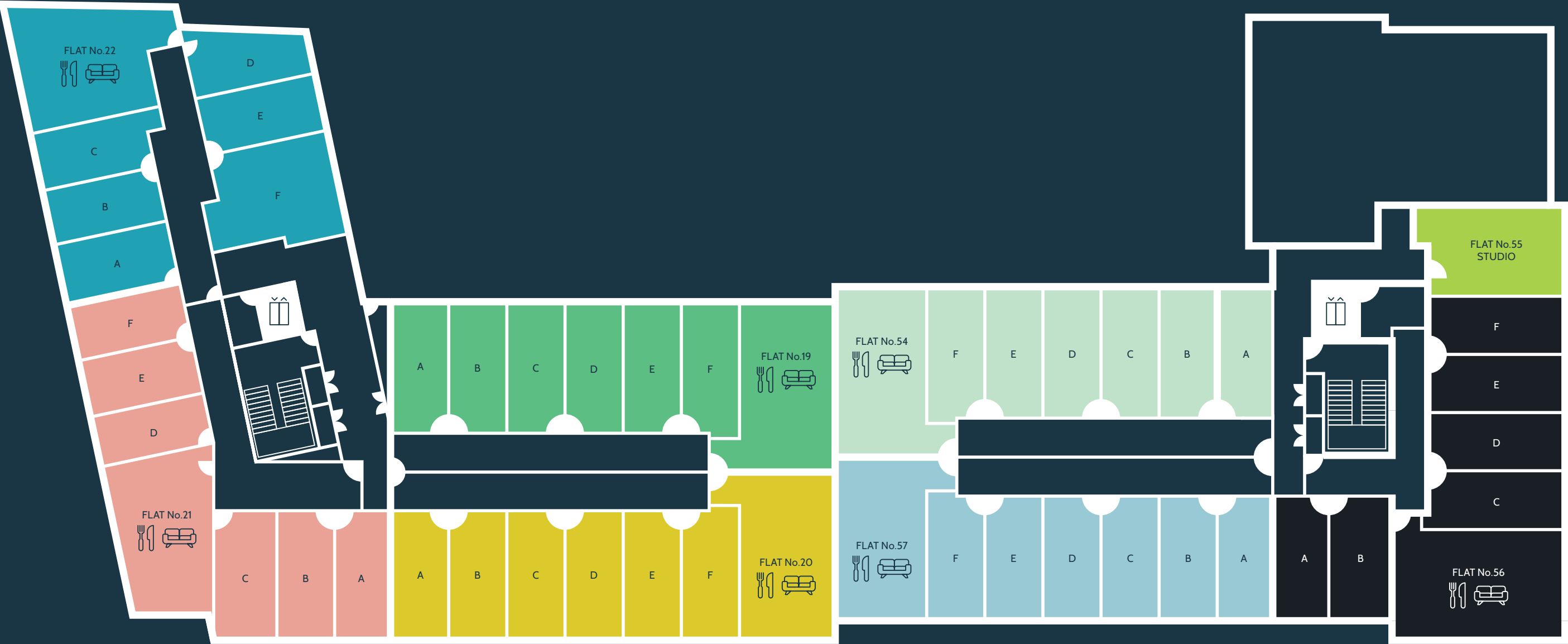

### Key

- |                 |             |             |             |
|-----------------|-------------|-------------|-------------|
| Lift / elevator | Flat No. 19 | Flat No. 22 | Flat No. 56 |
| Kitchen         | Flat No. 20 | Flat No. 54 | Flat No. 57 |
| Lounge          | Flat No. 21 | Flat No. 55 |             |

# GLASS WORKS

## Sixth floor

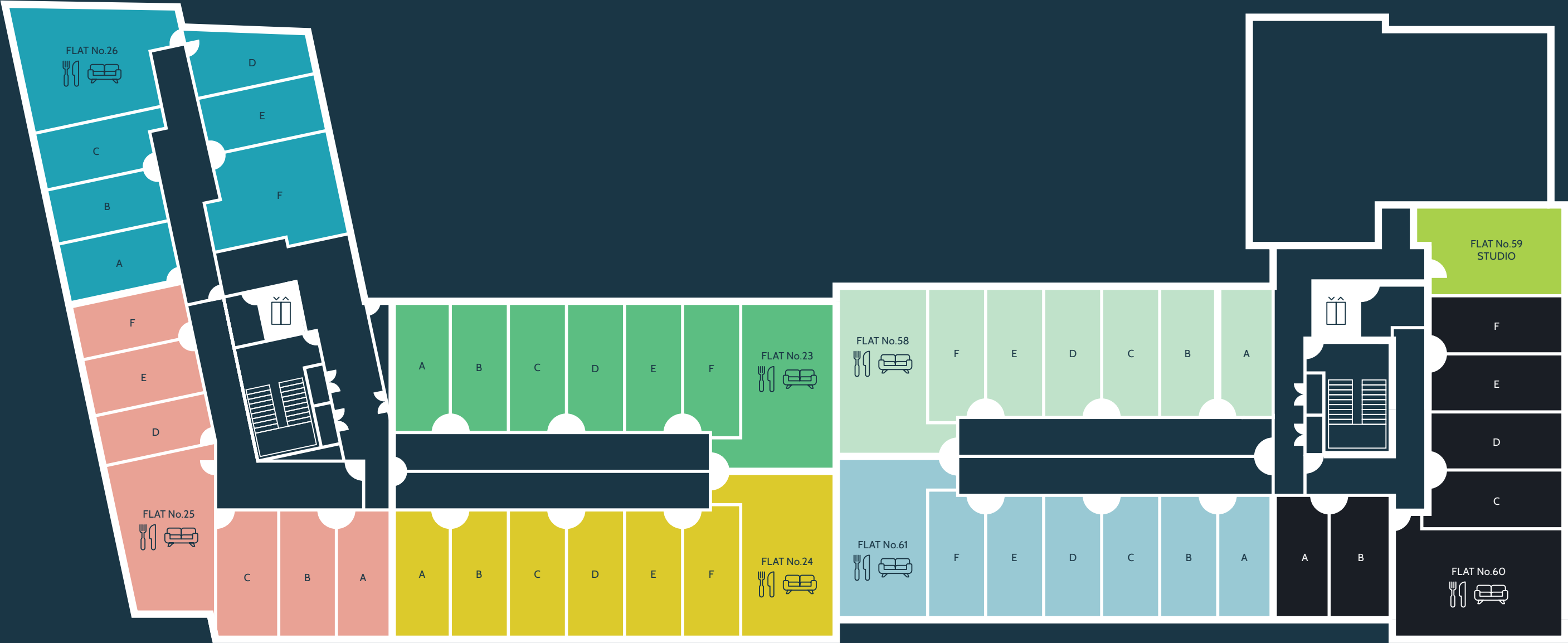

### Key

- |                 |             |             |             |
|-----------------|-------------|-------------|-------------|
| Lift / elevator | Flat No. 23 | Flat No. 26 | Flat No. 60 |
| Kitchen         | Flat No. 24 | Flat No. 58 | Flat No. 61 |
| Lounge          | Flat No. 25 | Flat No. 59 |             |

# GLASS WORKS

## Seventh floor



### Key

- |                 |             |             |
|-----------------|-------------|-------------|
| Lift / elevator | Flat No. 27 | Flat No. 30 |
| Kitchen         | Flat No. 28 |             |
| Lounge          | Flat No. 29 |             |